

PROSPETTO
Scala 1:5

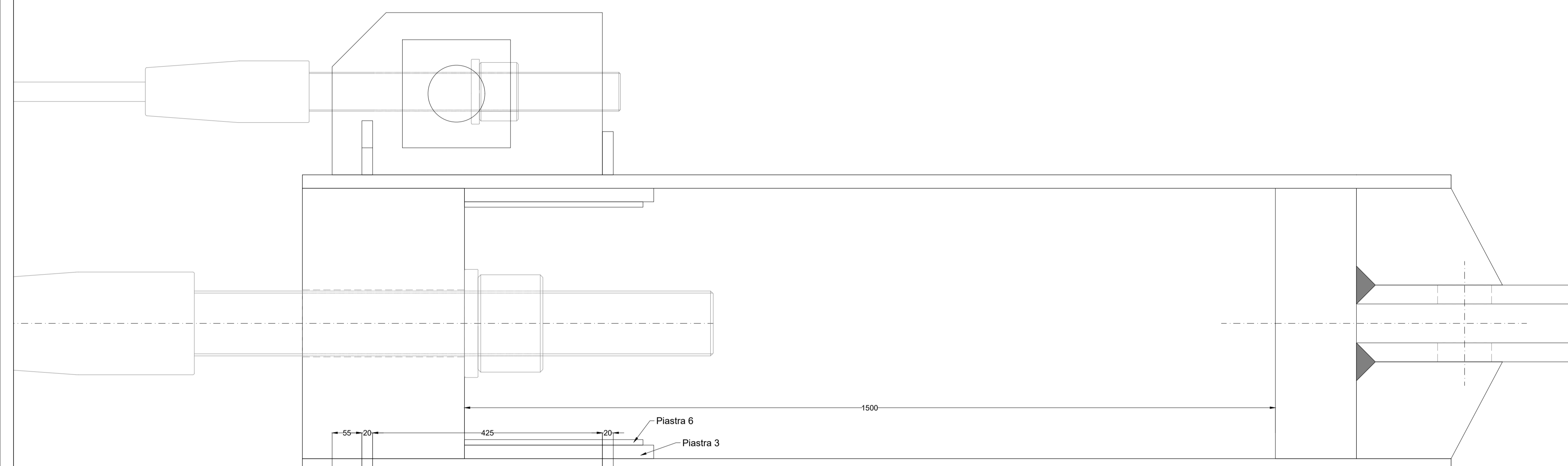

PIANTA
Scala 1:5

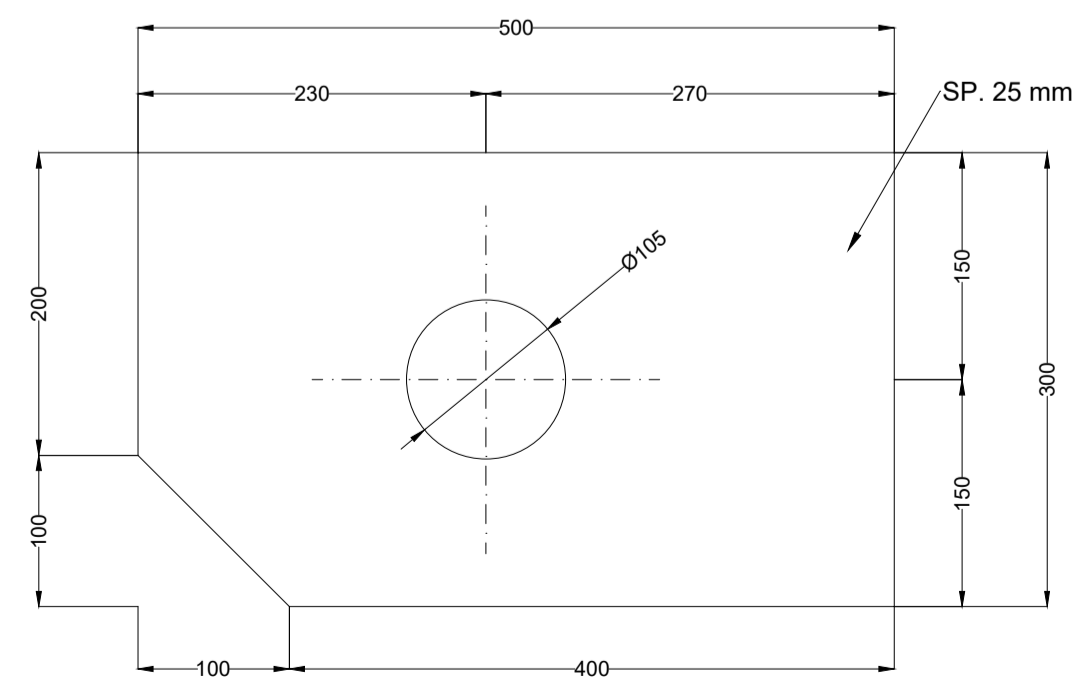

PARTICOLARE PIASTRA 1
Scala 1:5

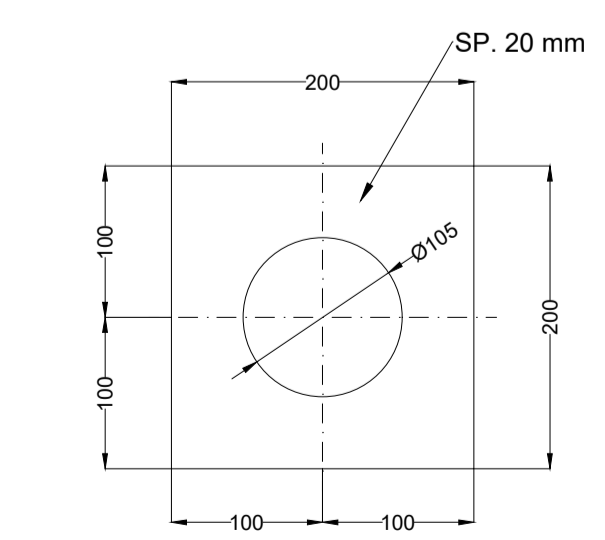

PARTICOLARE PIASTRA 2
Scala 1:5

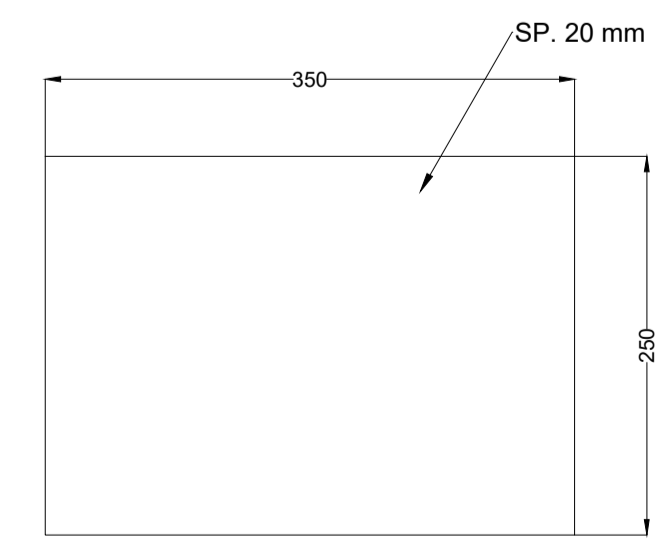

PARTICOLARE PIASTRA 3
Scala 1:5

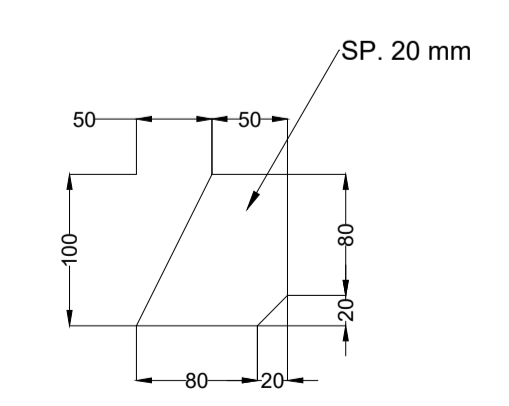

PARTICOLARE PIASTRA 4
Scala 1:5

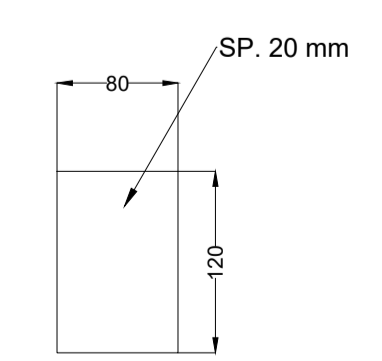

PARTICOLARE PIASTRA 5
Scala 1:5

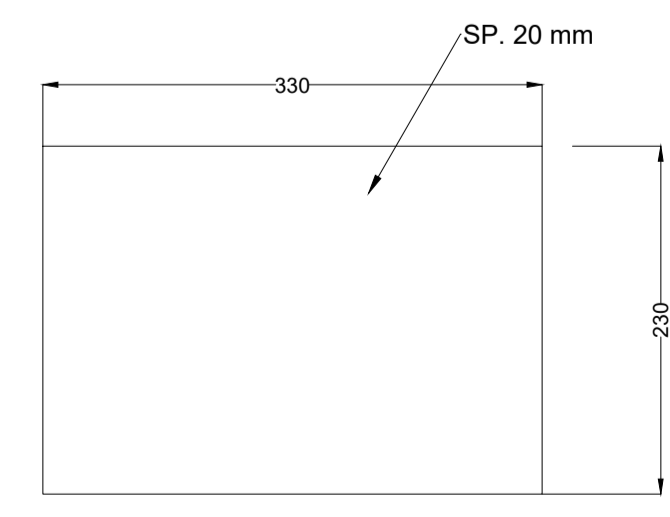

PARTICOLARE PIASTRA 6
Scala 1:5

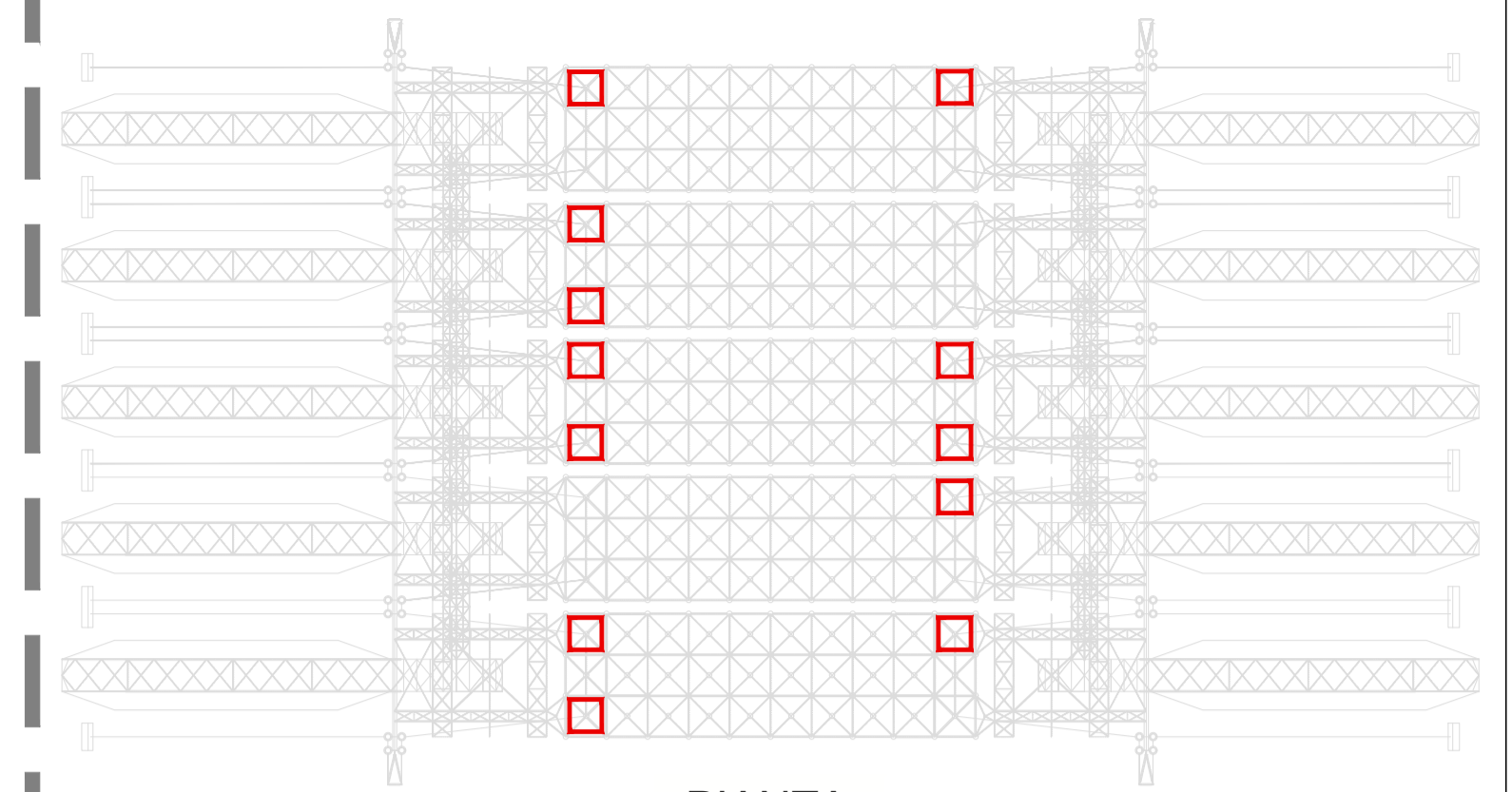

PIANTA

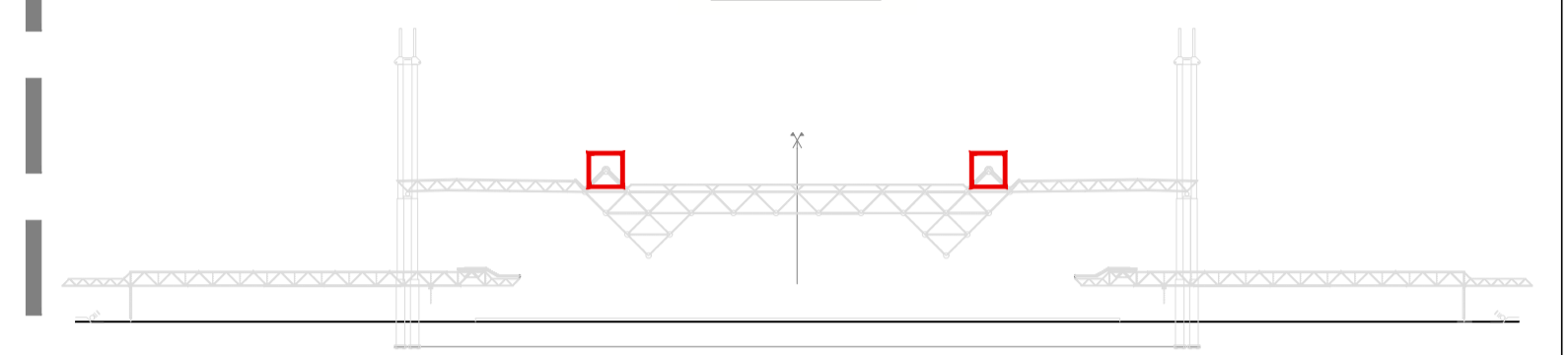

SEZIONE

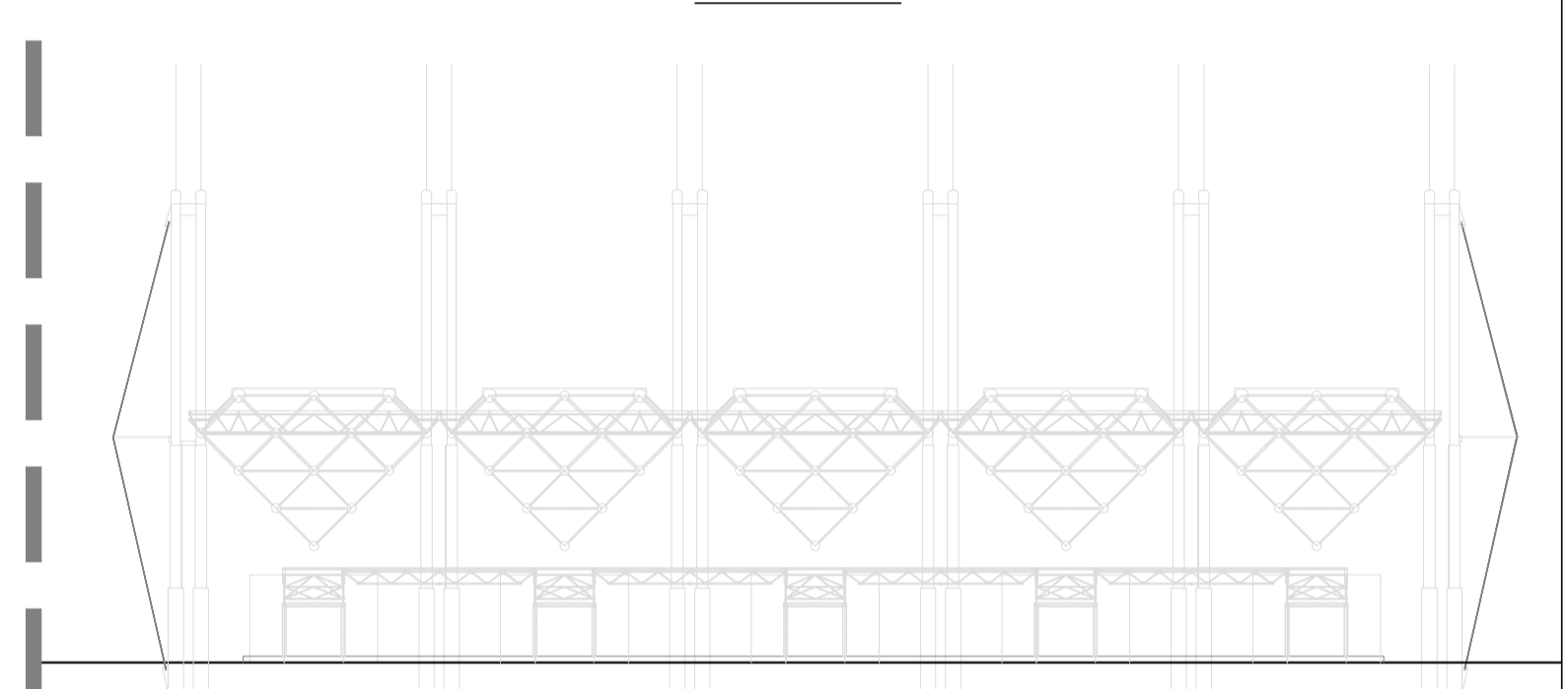

PROSPETTO

 **A.O. OPERE PUBBLICHE E PROTEZIONE CIVILE**
Servizio 3 - Gestione del Territorio

INTERVENTO DI MANUTENZIONE STRAORDINARIA PER LA MESSA IN SICUREZZA DELL'IMMOBILE DENOMINATO MERCATO DEI FIORI" - 1° STRALCIO FUNZIONALE

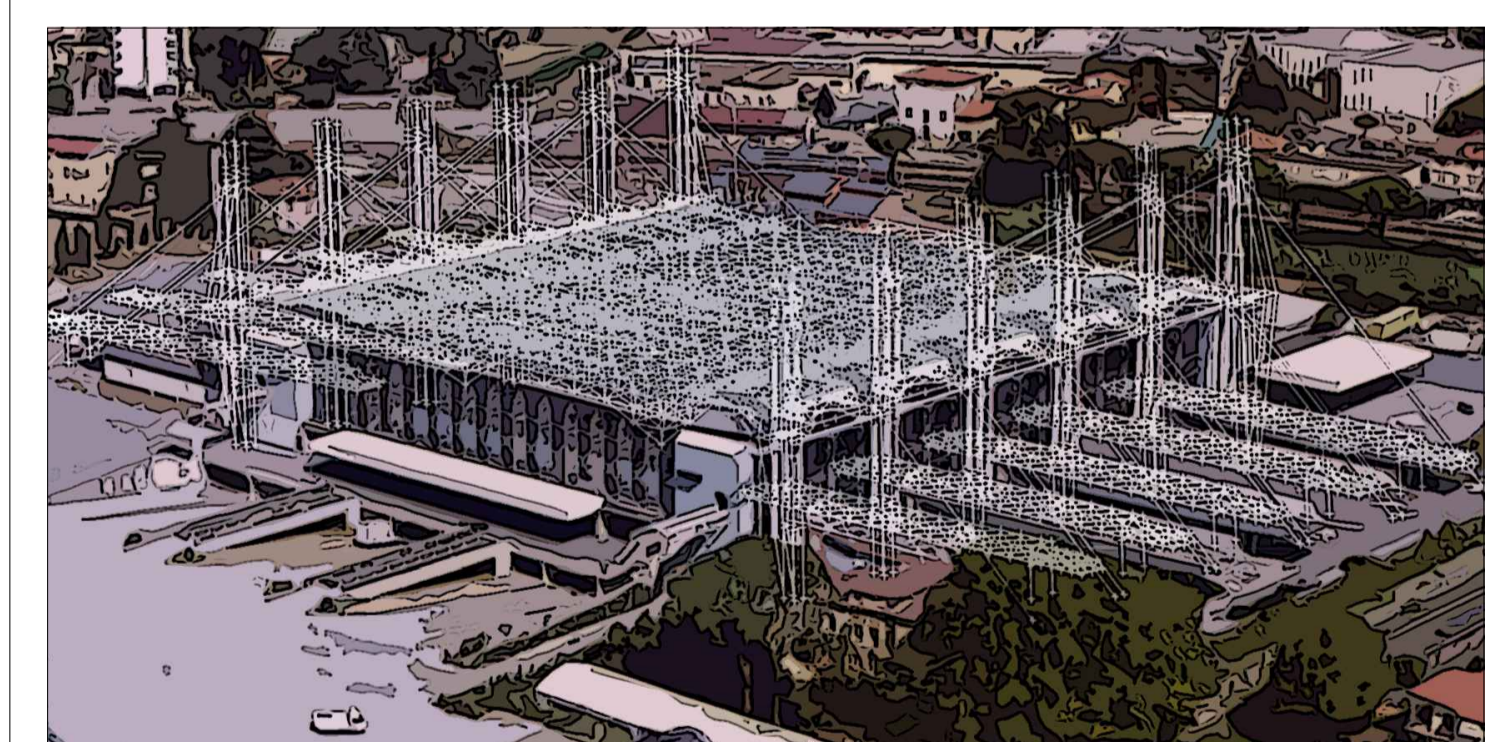

PROGETTO ESECUTIVO

TAV.S12 - STRUTTURALE - DETTAGLIO COLLEGAMENTI FUNI 3/3 - STATO DI PROGETTO

Pesca, lì 26 Giugno 2018

R.U.P.
Geom. Luciano BIANCHI

Raggruppamento Temporaneo di Professionisti

 **DP INGEGNERIA s.r.l.**
Società di Ingegneria Civile
Via Giuseppe Garibaldi 401 - 05100 - LECCE - Tel. Fax. 0832 893705 - P.IVA 0268994028

Mandatari
Arch. Sergio MARTINELLI
Ing. Alessandro DEL TOZZOTTO
Ing. Giacomo LENCONI
P.I. Gabriele BONOFILIO
Ing. Francesco BARTOLI